

Prasun Morya

Floor Plan

Typical 1st, 2nd, 3rd, 4th, 5th & 6th



Area Statement in Sq.m

Flat No.	Flat Type	Carpet	Balcony/Terrace	Total Carpet	Total Carpet (sq.ft.)
101,201,301,401,501,601	2 BHK	56.25	4.95	61.20	658.75
102,202,302,402,502,602	1 BHK	39.06	4.80	43.86	472.10
103,203,303,403,503,603	2 BHK	57.85	4.95	62.80	675.97
104,204,304,404,504,604	2 BHK	58.28	4.95	63.23	680.60
105,205,305,405,505,605	1 BHK	39.06	4.80	43.86	472.10
106,206,306,406,506,606	2 BHK	57.80	4.95	62.75	675.44

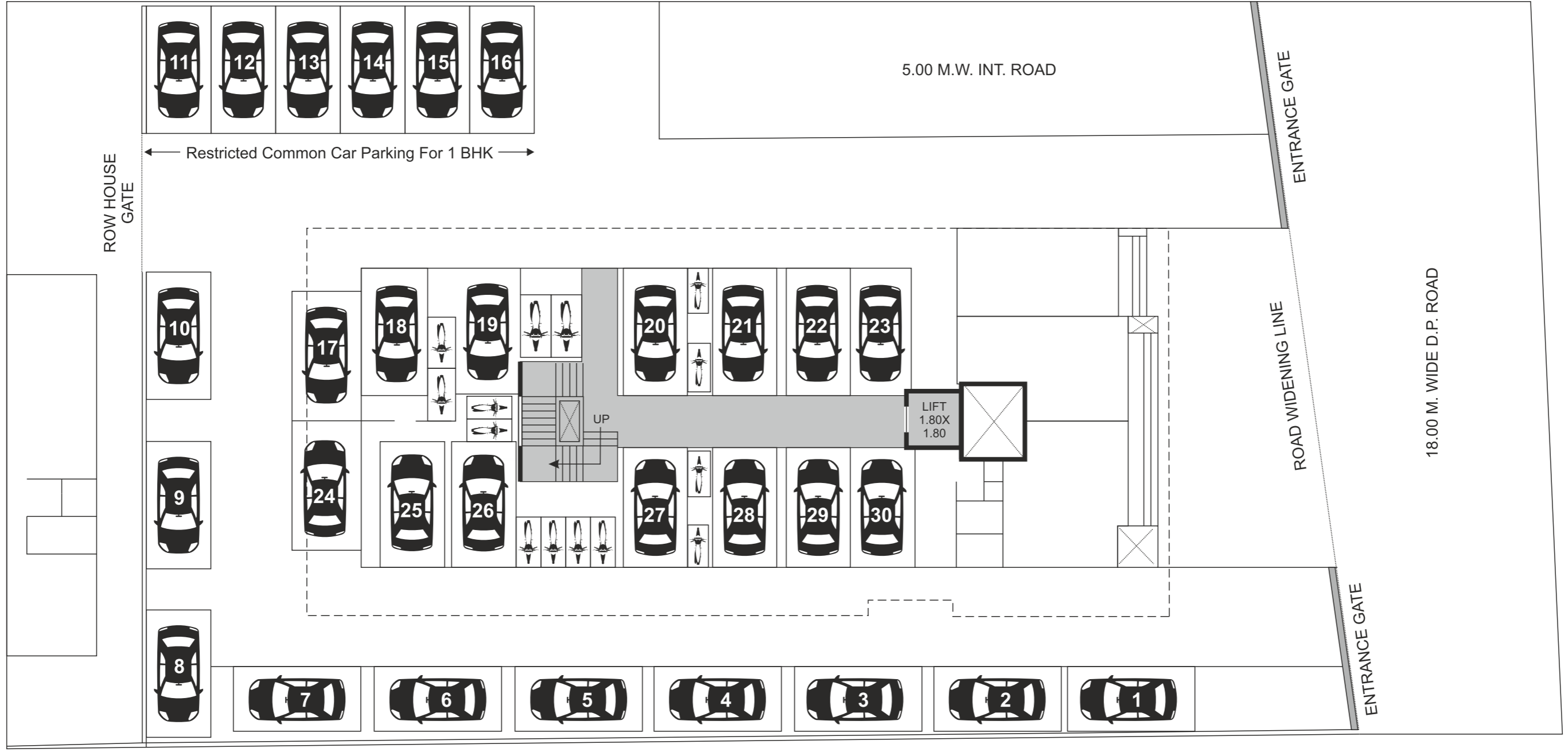

Prasun Morya

Parking Floor Plan

